

C THIS DRAWING IS COPYRIGHT PROTECTED AND MAY NOT BE REPRODUCED IN WHOLE OR IN PART WITHOUT WRITTEN AUTHORITY FROM THE OWNER.

NOTES:

1. Do not scale from this drawing.
2. Always work to noted dimensions.
3. All dimensions are in millimetres unless otherwise stated.
4. All setting out, levels and dimensions to be agreed on site.
5. The dimensions of all materials must be checked on site before being laid out.
6. This drawing must be read with the relevant specification clauses and detail drawings.
7. Order of construction and setting out to be agreed on site.

Refer to the associated written specification for the containers.

LOCATION PLAN - 1:150

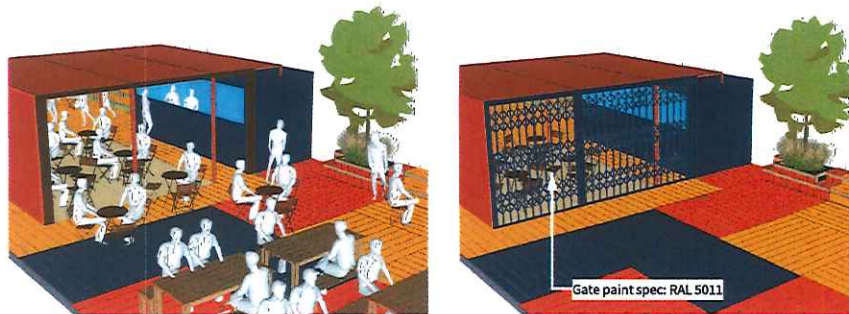

COLLAPSIBLE GATE OPTIONS



- Cafe/bar outlet container to incorporate roll top side and hatch allowing premises to be locked. Design to be confirmed.



- Collapsible gate fixings at either end of the canopy to allow furniture storage, container security and prevent possible usage of the sheltered space outside operational hours. A folding gate would make spatial sense and allow easy but secure locking for both sides of the sheltered area.

- Top hung collapsible gate quote approx. £5k per side (Bolton Gate Company) - Example images left

SI-PH4	20/08/21	For Construction	BM	GB
SI-PH3	18/06/21	For Construction	BM	GB
SI-PH2	17/12/20	For Tender	BM	GB
SI-PH1	04/02/20	For Planning	BM	GB

Revision | Date | Description | Drawn | Approved

		Plants L.E. Limited Manchester 2 Black Crofton St, Abchurch, W4A 1JY T: 0145 510 9191 LONDON Unit 6, Watlington, 44-46 Watford Road, London, N1 7UL T: 0207 543 8818 LIVERPOOL Tempus S.S. 12, Fishburns Square, Liverpool, L2 2SF T: 0151 940 1200	
Client:	Linen Quarter BID		
Project:	Brunswick Street		
Eng Title:	Container Study		
Created on:	06/11/20	Created by:	BM
Approved by:	GB	Scale:	Site
Worksheets:	A3	Construction	
Eng No.:	2574-PLA-XXX-DR-1-1002	Revisions:	S1 P04

- NOTES:**
1. Do not scale from this drawing.
 2. Always work to noted dimensions.
 3. All dimensions are in millimetres unless otherwise stated.
 4. All setting out, levels and dimensions to be agreed on site.
 5. The dimensions of all materials must be checked on site before being laid out.
 6. This drawing must be read with the relevant specification clauses and detail drawings.
 7. Order of construction and setting out to be agreed on site.

- KEY**
- Timber decking (repainted scaffold boards laid flush with container floor)
 - Timber clad bleacher seating (on timber frame structure)
 - F&B outlet and games hire (shipping container)
 - Shipping container seating shelter with feature graphic cut out
 - Proposed tree in planter
 - Existing street tree

SI-PLA	25/10/21	For Construction	BM	GS
SI-PLA	17/12/20	For Tender	BM	GS
SI-PLA	02/02/20	For Planning	BM	GS
SI-PLA	15/11/20	For Planning	BM	LH

Revision	Date	Description	Drawn	Approved

Planit L.E. Limited
 E: info@planit-le.com W: planit-le.com
 MANCHESTER
 2 South Colton St, Altrincham, WALK 12Y
 T: 0161 578 9781
 LONDON
 101 Chiswick Rd, 44-48 Wharf Road, London, N1 7JL
 T: 020 7303 6618
 LINCOLN
 The Old Mill, 12 Fishburn Street, Linnopolis, LN2 2DT
 T: 01522 363 1238

Client: Linen Quarter BID

Project: Brunswick Street

Proj Title: General Arrangement

Created on: 27/10/20 Created by: BM Approved by: LH

Scale: 1:200 Site: Workstage

Subsidiary: Construction

Proj No.: 2574-PLA-XX-DR-L-1000 Substage: 51 Revision: PD4

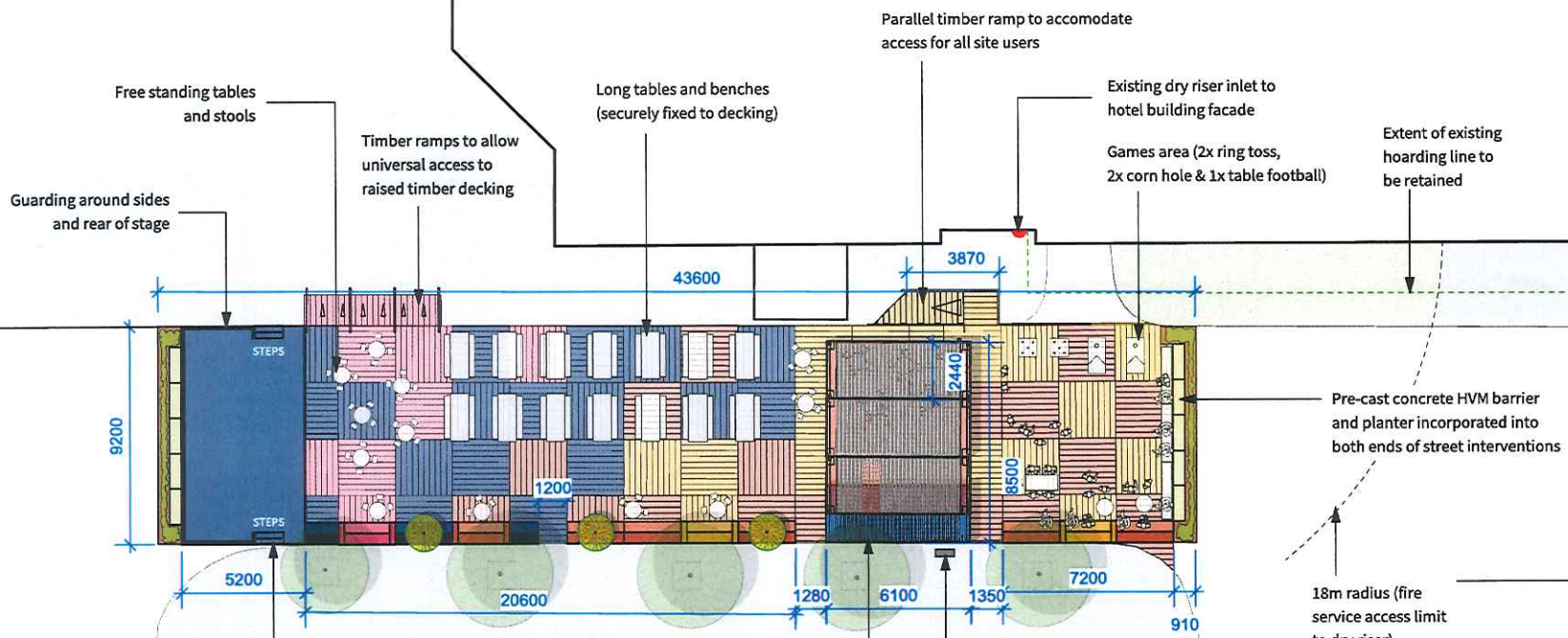

Free standing tables and stools

Timber ramps to allow universal access to raised timber decking

Long tables and benches (securely fixed to decking)

Parallel timber ramp to accommodate access for all site users

Existing dry riser inlet to hotel building facade

Games area (2x ring toss, 2x corn hole & 1x table football)

Extent of existing hoarding line to be retained

Guarding around sides and rear of stage

Pre-cast concrete HVM barrier and planter incorporated into both ends of street interventions

18m radius (fire service access limit to dry riser)

Stepped access to stage area from the side. Potential addition of stage gantry at later date.

Lockable 20" container to house cafe/bar unit. Food preparation off premises. Two high cube 20" containers adjacent, acting as a canopy.

NI Water connection point

See Like Architects drawings for outlet container details and layout.



Indicative visualisation

